

Kwikstrut Channelnuts - Galvanised

Kwikstrut Uni lock channel nut

Material : Screw DIN 933-8.8; Nut Steel DD11 - EN 10111; Washer Steel DX51D-Z275 EN 10327

Finish : Electro zinc plated - EN ISO 12329

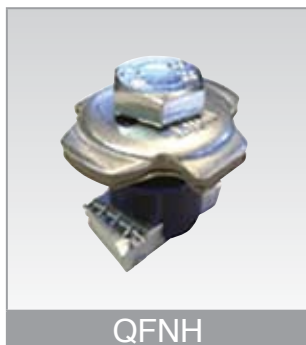

QFNH

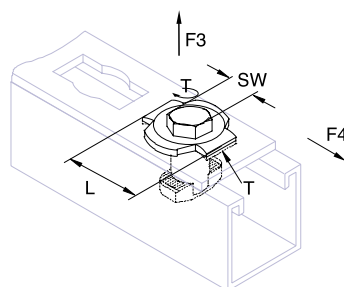

Art.Nr.	G	L mm	T mm	F3 kN	F4 kN	Tinst Nm	SW	kg /100	
1391016	M10	40	4.0	4.0	3.0	40	17	10	50

Also available in finish Deltatone

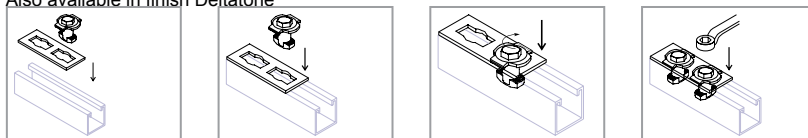

Kwikstrut channel nut with square washer

Material : Nut S460MC - EN 10149; Washer Steel DX51 - EN 10327

Finish : Electro zinc plated - EN ISO 12329

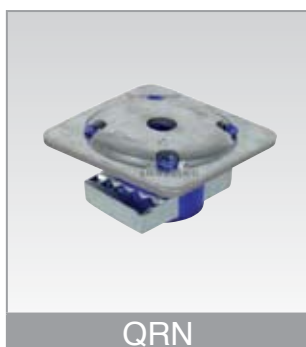

QRN

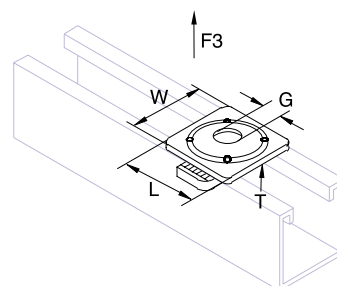

Art.Nr.	G	L mm	W mm	T mm	F3 kN	kg /100	
1390621	M6	40	40	2.5	5.0	6.2	50
1390821	M8	40	40	2.5	5.0	6	50
1391021	M10	40	40	2.5	5.0	5.8	50
1391221	M12	40	40	2.5	5.0	5.5	50

Also available in finish Deltatone

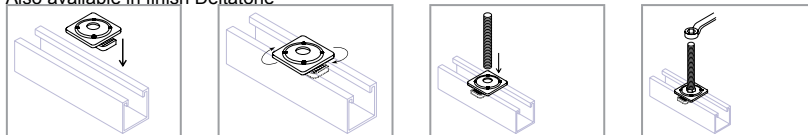

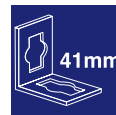

Kwikstrut Channelnuts - Galvanised

Kwikstrut channel nut with plastic locater

Material : Nut S460MC - EN 10149; Washer Polyamid

Finish : Electro zinc plated - EN ISO 12329

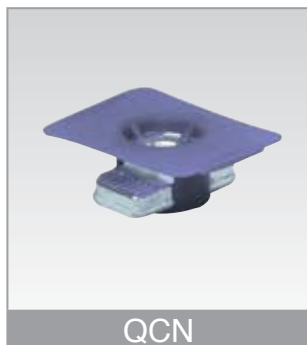

QCN

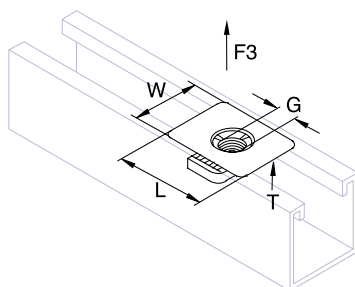

Art.Nr.	G	L mm	W mm	T mm	F3 kN	kg /100	
1390631	M6	45	34	0.8	5.0	3.5	50
1390831	M8	45	34	0.8	5.0	3.3	50
1391031	M10	45	34	0.8	5.0	3	50
1391231	M12	45	34	0.8	5.0	2.8	50

Also available in finish Deltatone

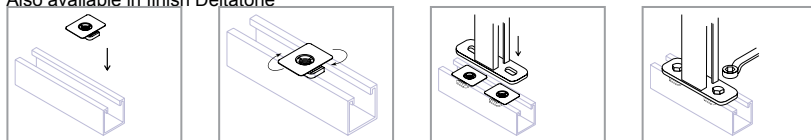

Kwikstrut channel nut M16 or 1/2"

Material : Steel DD11 - EN 10111

Finish : Electro zinc plated - EN ISO 12329



QEN

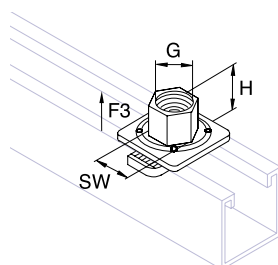

Art.Nr.	G	H mm	F3 kN	SW	kg /100	
1391621	M16	26	5.0	22	9.5	50
1392226	1/2	26	5.0	27	11.5	50

Also available in finish Deltatone

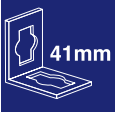

2.015

Kwikstrut Channelnuts - Galvanised

Kwikstrut stud nuts

Material : Nut S460MC - EN 10149; Washer Steel DX51 - EN 10327

Finish : Electro zinc plated - EN ISO 12329

2d

Kwikstrut Fittings 41mm

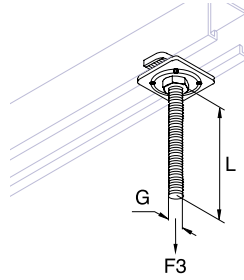

Art.Nr.	G	L mm	F3 kN	kg /100	
1390251	M8	25	5.0	8.5	100
1390501	M8	50	5.0	9.2	100
1391001	M8	100	5.0	10.6	100
1391508	M8	150	5.0	12.2	100
1392001	M8	200	5.0	12.9	100
1390253	M10	25	5.0	10	100
1390503	M10	50	5.0	11	100
1391003	M10	100	5.0	12.9	100
1391500	M10	150	5.0	15.6	100
1392003	M10	200	5.0	16.8	100
1390255	M12	25	5.0	11.5	100
1390505	M12	50	5.0	12.9	100
1391005	M12	100	5.0	16.2	100
1391505	M12	150	5.0	19.7	100
1392002	M12	200	5.0	21.5	100

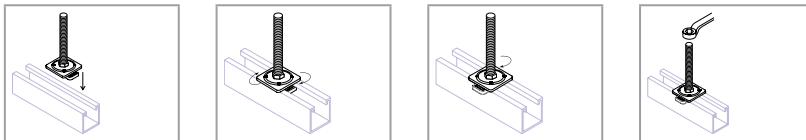

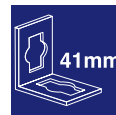

Kwikstrut Angle Fittings - Galvanised

Kwikstrut flat angle fitting 90°

Material : Steel DD11 - EN 10111

Finish : Electro zinc plated - EN ISO 12329

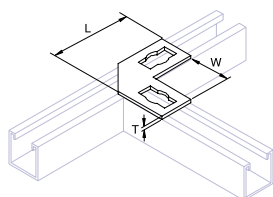

Art.Nr.	L mm	W mm	T mm	Number of Holes	Kg /100	
1390125	92	52	4.0	1&1	12.5	25

Also available in finish Deltatone

Kwikstrut T-fitting

Material : Steel DD11 - EN 10111

Finish : Electro zinc plated - EN ISO 12229

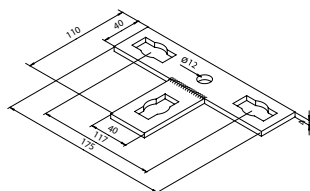
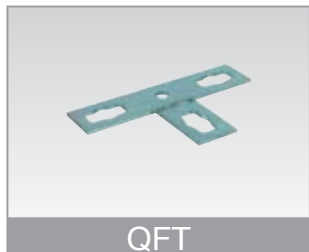

Art.Nr.	L mm	T mm	Number of Holes	Kg /100	
1390146	150	4.0	1&3	18.7	25

Kwikstrut cross fitting

Material : Steel DD11 - EN 10111

Finish : Electro zinc plated - EN ISO 12229

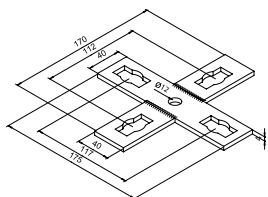
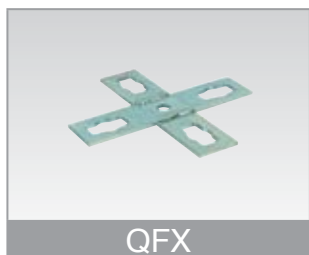

Art.Nr.	L mm	W mm	T mm	Number of Holes	Kg /100	
1390145	170	170	4.0	2&2	25.0	25

2e

Kwikstrut Fittings 41mm

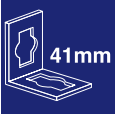

2.017

Kwikstrut Angle Fittings - Galvanised

Kwikstrut flat angle fitting 90°

Material : Steel DD11 - EN 10111

Finish : Electro zinc plated - EN ISO 12329

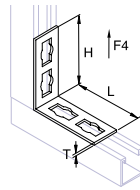
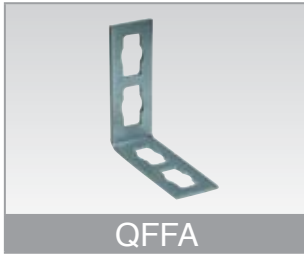

Art.Nr.	L mm	H mm	T mm	F4 kN	Number of Holes	kg /100	
1399025	65	65	4.0	2.0	1&1	10.9	25
1399035	65	110	4.0	2.0	1&2	14.6	25
1399045	110	110	4.0	3.0	2&2	18.6	25

Also available in finish Deltatone

Kwikstrut flat angle fitting 135°

Material : Steel DD11 - EN 10111

Finish : Electro zinc plated - EN ISO 12329

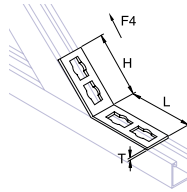

Art.Nr.	L mm	H mm	T mm	F4 kN	Number of Holes	kg /100	
1393535	65	110	4.0	2.0	1&2	14.3	25
1393545	110	110	4.0	3.0	2&2	18	25

Also available in finish Deltatone

Kwikstrut angle fitting 90°

Material : Steel DD11 - EN 10111

Finish : Electro zinc plated - EN ISO 12329

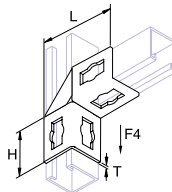

Art.Nr.	L mm	H mm	T mm	F4 kN	Number of Holes	kg /100	
1399055	103	58	4.0	2.0	2&2	24.9	10
1399065	150	106	4.0	3.0	4&4	40.8	10

Also available in finish Deltatone

2e

Kwikstrut Fittings 41mm

TYCENSUP 06/09

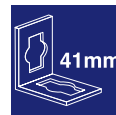

Kwikstrut Angle Fittings - Galvanised

Kwikstrut angle fitting 135°

Material : Steel DD11 - EN 10111

Finish : Electro zinc plated - EN ISO 12329

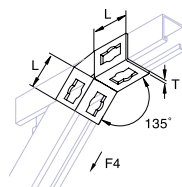

QFA 135

Art.Nr.	L mm	T mm	F4 kN	Number of Holes	kg /100	
1393555	56	4.0	2.0	2&2	38	10
1393565	103	4.0	3.0	4&4	39	10

Also available in finish Deltatone

Kwikstrut angle fitting 45°

Material : Steel DD11 - EN 10111

Finish : Electro zinc plated - EN ISO 12329

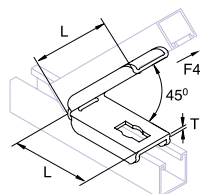

QFFA45

Art.Nr.	L mm	T mm	F4 kN	Number of Holes	kg /100	
1394525	104	5.0	2.0	1&1	46	25

Also available in finish Deltatone

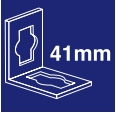

2.019

Kwikstrut Special Fittings - Galvanised

Kwikstrut angle - T fitting

Material : Steel DD11 - EN 10111

Finish : Electro zinc plated - EN ISO 12329

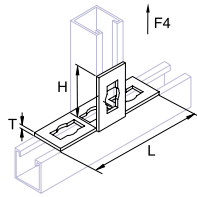
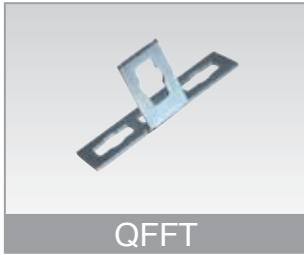

QFFT

Art.Nr.	L mm	H mm	T mm	F4 kN	Number of Holes	Kg /100	
1390115	150	66	4.0	2.0	1&3	18.7	25

Also available in finish Deltatone

Kwikstrut cross fitting

Material : Steel DD11 - EN 10111

Finish : Electro zinc plated - EN ISO 12329

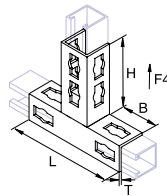
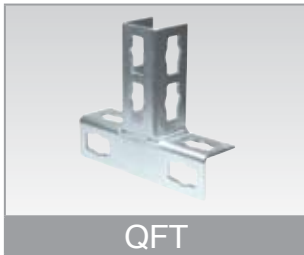

QFT

Art.Nr.	L mm	H mm	T mm	F4 kN	Number of Holes	Kg /100	
1394118	175	108	4.0	3.0	6&4	69	25

Also available in finish Deltatone

Kwikstrut U shaped fitting

Material : Steel DD11 - EN 10111

Finish : Electro zinc plated - EN ISO 12329

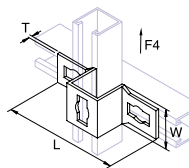
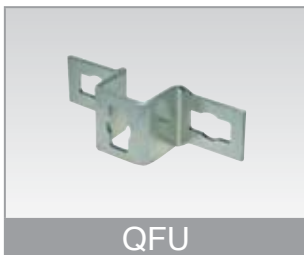

QFU

Art.Nr.	L mm	W mm	T mm	F4 kN	Number of Holes	Kg /100	
1394138	162	52	4.0	2.0	2&1	29.1	25

Also available in finish Deltatone

2f

Kwikstrut Fittings 41mm

TYCENSUP 06/09

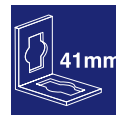

Kwikstrut Special Fittings - Galvanised

Kwikstrut 3 way cross fitting

Material : Steel DD11 - EN 10111

Finish : Electro zinc plated - EN ISO 12329

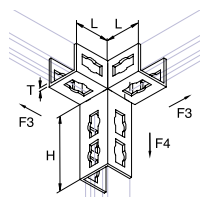

Art.Nr.	L mm	H mm	T mm	F3 kN	F4 kN	Number of Holes	$\frac{Kg}{100}$	
1394111	62	107	4.0	2.0	3.0	6&3&3	66	10
1394112	62	107	4.0	2.0	3.0	6&3&3	66	10

Also available in finish Deltatone

Kwikstrut 4 way cross fitting

Material : Steel DD11 - EN 10111

Finish : Electro zinc plated - EN ISO 12329

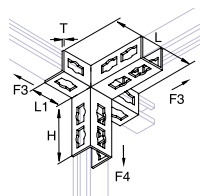
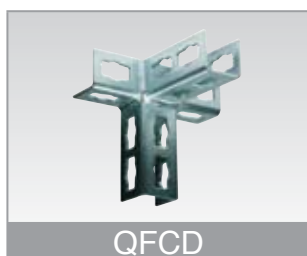

Art.Nr.	L mm	L1 mm	H mm	T mm	F3 kN	F4 kN	Number of Holes	$\frac{Kg}{100}$	
1394178	175	62	108	4.0	2.0	3.0	6&3&4	110	10

Also available in finish Deltatone

Kwikstrut rod connection fitting

Material : Steel DD11 - EN 10111

Finish : Electro zinc plated - EN ISO 12329

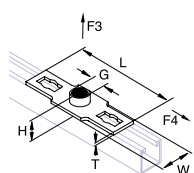

Art.Nr.	G	L mm	W mm	H mm	T mm	F3 kN	F4 kN	Number of Holes	$\frac{Kg}{100}$	
1390825	M8	176	56	13	5.0	5.0	3.0	2	27.4	25
1391025	M10	176	56	13	5.0	5.0	3.0	2	27.2	25
1391225	M12	176	56	15	5.0	5.0	3.0	2	27.4	25
1391625	M16	176	56	18	5.0	5.0	3.0	2	30.6	25
1392225	1/2"	176	56	20.5	5.0	5.0	3.0	2	29.7	25
1392825	3/4"	176	56	22.5	5.0	5.0	3.0	2	30.9	25

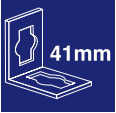

2.021

Kwikstrut Special Fittings - Galvanised

Kwikstrut adjustable rod connection fitting

Material : Steel DD11 - EN 10111

Finish : Electro zinc plated - EN ISO 12329

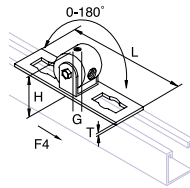

Art.Nr.	G	L mm	H mm	T mm	F4 kN	Number of Holes	kg /100	
1390135	M8/M10/M12	150	53	5.0	3.0	2	51.4	10

Kwikstrut adjustable angle fitting

Material : Steel DD11 - EN 10111

Finish : Electro zinc plated - EN ISO 12329

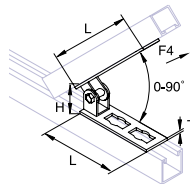
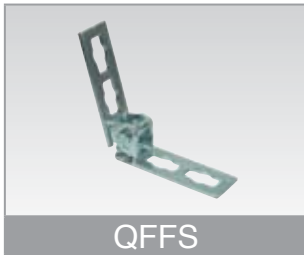

Art.Nr.	L mm	H mm	T mm	F4 kN	Number of Holes	kg /100	
1390185	122	55	5.0	3.0	2&2	44.8	10

Kwikstrut adjustable angle - T fitting

Material : Steel DD11 - EN 10111

Finish : Electro zinc plated - EN ISO 12329

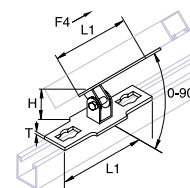

Art.Nr.	L mm	L1 mm	H mm	T mm	F4 kN	Number of Holes	kg /100	
1390195	122	176	55	5.0	3.0	2&2	51	10

Also available in finish Deltatone

2f

Kwikstrut Fittings 41mm

TYCENSUP 06/09

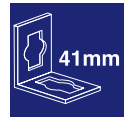

Kwikstrut Special Fittings - Galvanised

Kwikstrut channel coupler

Material : Steel DD11 - EN 10111

Finish : Electro zinc plated - EN ISO 12329

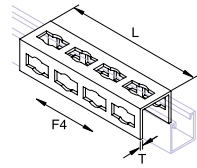
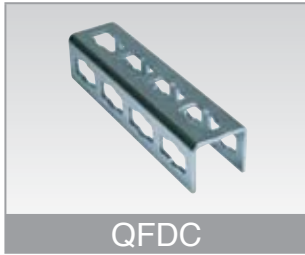

QFDC

Art.Nr.	L mm	T mm	F4 kN	Number of Holes	kg /100	
1394148	193	4.0	3.0	12	51	10

Also available in finish Deltatone

2f

Kwikstrut Fittings 41mm

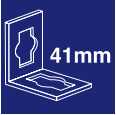

2.023

Kwikstrut Channel Base Fittings - Galvanised

Kwikstrut Channel Base Fittings

Material : Steel DD11 - EN 10111

Finish : Electro zinc plated - EN ISO 12329

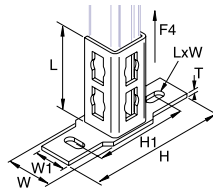

Art.Nr.	L mm	W mm	W1 mm	H mm	H1 mm	T mm	LxW mm	F4 kN	Number of Holes	Kg /100	
1394159		56	40	175	118	5	12.5x25	3.0	6	70.0	10

Kwikstrut Channel Base Fittings

Material : Steel DD11 - EN 10111

Finish : Electro zinc plated - EN ISO 12329

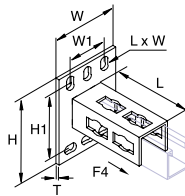

Art.Nr.	L mm	W mm	W1 mm	H mm	H1 mm	T mm	LxW mm	F4 kN	Number of Holes	Kg /100	
1394158	108	100	62	130	100	5.0	12.5x20	3.0	6	77.1	10

Also available in finish Deltatone

Kwikstrut Channel Base Fittings

Material : Steel DD11 - EN 10111

Finish : Electro zinc plated - EN ISO 12329

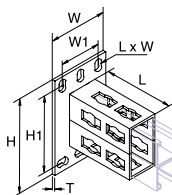

Art.Nr.	L mm	W mm	W1 mm	H mm	H1 mm	T mm	LxW mm	Number of Holes	Kg /100	
1394458	108	130	62	170	140	8.0	12.5x20	6&6	192	5

Also available in finish Deltatone

2g

Kwikstrut Fittings 41mm

TYCENSUP 06/09

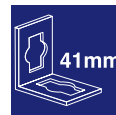

Kwikstrut Channel Base Fittings - Galvanised

Kwikstrut Channel Base Fittings

Material : Steel DD11 - EN 10111

Finish : Electro zinc plated - EN ISO 12329

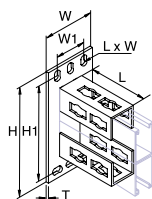

QB124

Art.Nr.	L mm	W mm	W1 mm	H mm	H1 mm	T mm	LxW mm	Number of Holes	kg /100	
1396658	108	130	62	210	180	8.0	12.5x20	6&6	224.6	5

Also available in finish Deltatone

2g

Kwikstrut Fittings 41mm