

## Kwikstrut Channelnuts - Deltatone

### Kwikstrut Uni lock channel nut

Material : Screw: DIN 933-8.8; Nut and Washer: Steel DD11 - EN 10111  
 Finish : Delta Tone - Corrosion resistance - EN ISO 9227

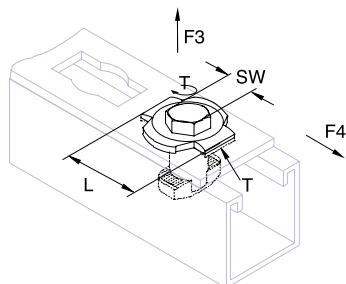

2ad

Kwikstrut Fittings 41mm

Art.Nr.	G	L mm	T mm	F3 kN	F4 kN	Tinst Nm	SW	kg /100	
1391019	M10	40	4.0	4.0	3.0	40	17	10	50

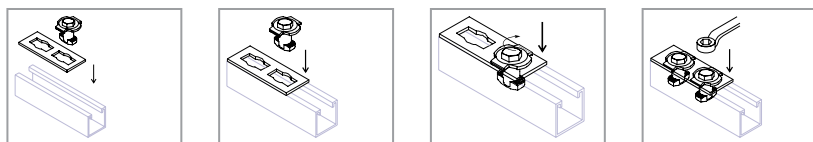

### Kwikstrut channel nut with square washer

Material : Nut: S460MC - EN 10149; Washer: Steel DD11 - EN 10111  
 Finish : Delta Tone - Corrosion resistance - EN ISO 9227

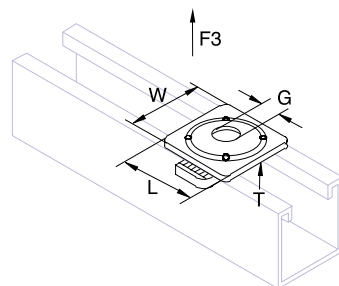

Art.Nr.	G	L mm	W mm	T mm	F3 kN	kg /100	
1390824	M8	40	40	2.5	5.0	6	50
1391024	M10	40	40	2.5	5.0	5.8	50
1391224	M12	40	40	2.5	5.0	5.5	50

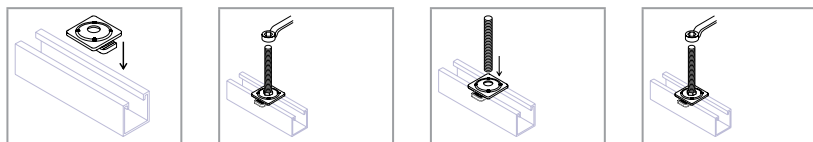

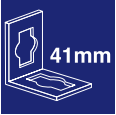

2.059

## Kwikstrut Channelnuts - Deltatone

**Kwikstrut channel nut with plastic washer**

Material : Steel DD11 - EN 10111

Finish : Delta Tone - Corrosion resistance - EN ISO 9227

2ad

Kwikstrut Fittings 41mm



QCN-HDG

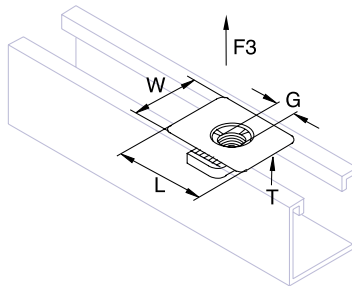

Art.Nr.	G	L mm	T mm	F3 kN	kg /100	
1390834	M8	45	0.8	5.0	3.3	50
1391034	M10	45	0.8	5.0	3	50
1391234	M12	45	0.8	5.0	2.8	50

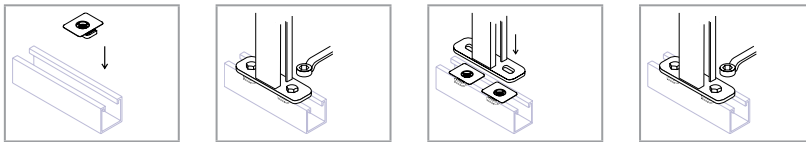

**Kwikstrut channel nut M16 or 1/2"**

Material : Steel DD11 - EN 10111

Finish : Delta Tone - Corrosion resistance - EN ISO 9227



QEN-HDG

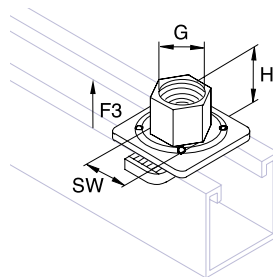

Art.Nr.	G	H mm	F3 kN	SW	kg /100	
1391624	M16	26	5.0	22	1.9	50
1392224	1/2	26	5.0	27	11.5	50

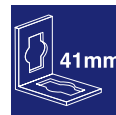

## Kwikstrut Angle Fittings - Deltatone

### Kwikstrut flat angle fitting 90°

Material : Steel DD11 - EN 10111

Finish : Delta Tone - Corrosion resistance - EN ISO 9227

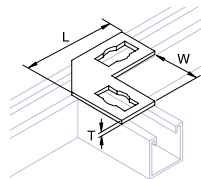

Art.Nr.	L mm	W mm	T mm	Number of Holes	$\frac{\text{Kg}}{100}$	
1390124	92	52	4.0	1&1	12.5	25

### Kwikstrut flat angle fitting 90°

Material : Steel DD11 - EN 10111

Finish : Delta Tone - Corrosion resistance - EN ISO 9227

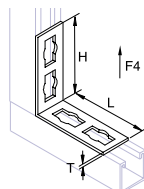

Art.Nr.	L mm	H mm	T mm	F4 kN	Number of Holes	$\frac{\text{Kg}}{100}$	
1399024	65	65	4.0	2.0	1&1	10.9	25
1399034	65	110	4.0	2.0	1&2	14.6	25
1399044	110	110	4.0	3.0	2&2	18.6	25

### Kwikstrut flat angle fitting 135°

Material : Steel DD11 - EN 10111

Finish : Delta Tone - Corrosion resistance - EN ISO 9227

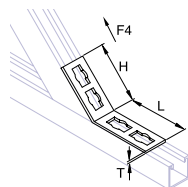
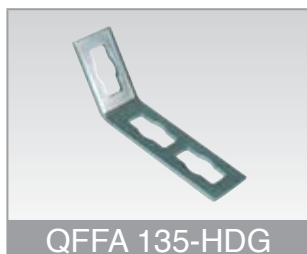

Art.Nr.	L mm	H mm	T mm	F3 kN	Number of Holes	$\frac{\text{Kg}}{100}$	
1393534	65	110	4.0	2.0	1&2	24.9	25
1393544	110	110	4.0	3.0	2&2	18	25

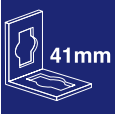

2.061

## Kwikstrut Angle Fittings - Deltatone

### Kwikstrut angle fitting 90°

Material : Steel DD11 - EN 10111

Finish : Delta Tone - Corrosion resistance - EN ISO 9227

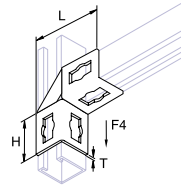

Art.Nr.	L mm	H mm	T mm	F4 kN	Number of Holes	kg /100	
1399054	103	58	4.0	2.0	2&2	24.9	10
1399064	150	106	4.0	3.0	4&4	40.8	10

### Kwikstrut angle fitting 135°

Material : Steel DD11 - EN 10111

Finish : Delta Tone - Corrosion resistance - EN ISO 9227

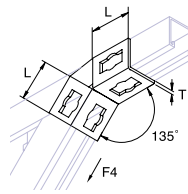

Art.Nr.	L mm	T mm	F4 kN	Number of Holes	kg /100	
1393554	56	4.0	2.0	2&2	24.9	10
1393564	103	4.0	3.0	4&4	39	10

### Kwikstrut angle fitting 45

Material : Steel DD11 - EN 10111

Finish : Delta Tone - Corrosion resistance - EN ISO 9227

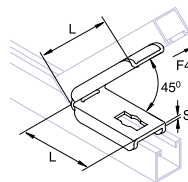

Art.Nr.	L mm	T mm	F4 kN	Number of Holes	kg /100	
1394524	104	5.0	3.0	1&1	46	25

2ae

Kwikstrut Fittings 41mm

TYCENSUP 06/09

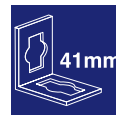

## Kwikstrut Special Fittings - Deltatone

### Kwikstrut angle - T fitting

Material : Steel DD11 - EN 10111

Finish : Delta Tone - Corrosion resistance - EN ISO 9227

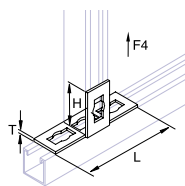
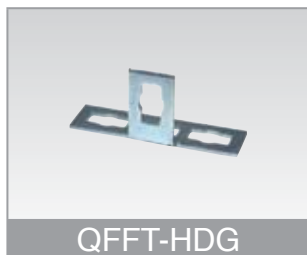

QFFT-HDG

Art.Nr.	L mm	H mm	T mm	F4 kN	Number of Holes	Kg /100	
1390114	150	66	4.0	2.0	1&3	18.7	25

### Kwikstrut cross fitting

Material : Steel DD11 - EN 10111

Finish : Delta Tone - Corrosion resistance - EN ISO 9227

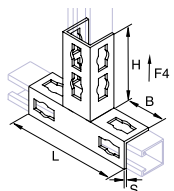
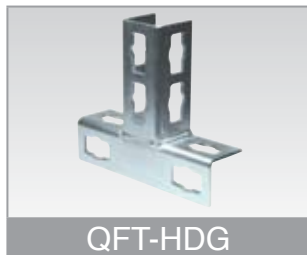

QFT-HDG

Art.Nr.	L mm	H mm	T mm	F4 kN	Number of Holes	Kg /100	
1394115	175	108	4.0	3.0	6&4	69	25

### Kwikstrut U shaped fitting

Material : Steel DD11 - EN 10111

Finish : Delta Tone - Corrosion resistance - EN ISO 9227

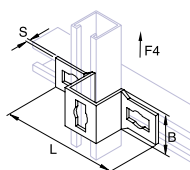

QFU-HDG

Art.Nr.	L mm	W mm	T mm	F4 kN	Number of Holes	Kg /100	
1394134	162	52	4.0	2.0	2&1	29.1	25

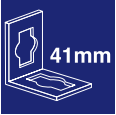

2.063

## Kwikstrut Special Fittings - Deltatone

### Kwikstrut 3 way cross fitting

Material : Steel DD11 - EN 10111

Finish : Delta Tone - Corrosion resistance - EN ISO 9227

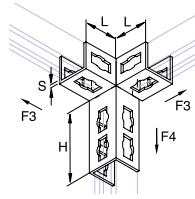
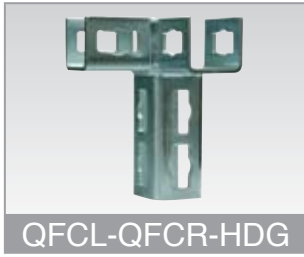

QFCL-QFCR-HDG

Art.Nr.	L mm	H mm	T mm	F3 kN	F4 kN	kg /100	
1394113	62	107	4.0	2.0	3.0	69	10
1394114	62	107	4.0	2.0	3.0	69	10

### Kwikstrut 4 way cross fitting

Material : Steel DD11 - EN 10111

Finish : Delta Tone - Corrosion resistance - EN ISO 9227

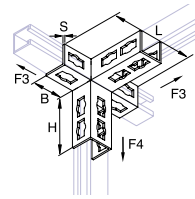
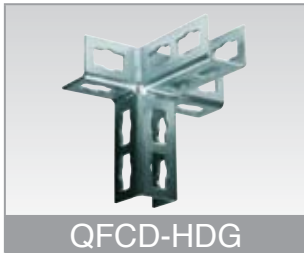

QFCD-HDG

Art.Nr.	L mm	L1 mm	H mm	T mm	F3 kN	F4 kN	Number of Holes	kg /100	
1394124	175	62	108	4.0	2.0	3.0	6&3&4	110	10

### Kwikstrut adjustable angle fitting

Material : Steel DD11 - EN 10111

Finish : Delta Tone - Corrosion resistance - EN ISO 9227

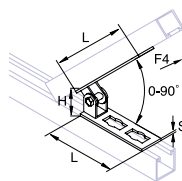

QFFS-HDG

Art.Nr.	L mm	H mm	T mm	F4 kN	Number of Holes	kg /100	
1390184	122	55	5.0	3.0	2&2	44.8	10

2af

Kwikstrut Fittings 41mm

TYCENSUP 06/09

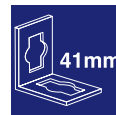

## Kwikstrut Special Fittings - Deltatone

### Kwikstrut adjustable angle - T fitting

Material : Steel DD11 - EN 10111

Finish : Delta Tone - Corrosion resistance - EN ISO 9227

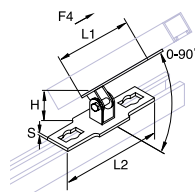

QFFSS-HDG

Art.Nr.	L mm	L1 mm	H mm	T mm	F4 kN	Number of Holes	kg /100	
1390194	122	176	55	5.0	3.0	2&2	51	10

### Kwikstrut channel coupler

Material : Steel DD11 - EN 10111

Finish : Delta Tone - Corrosion resistance - EN ISO 9227

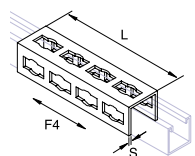

QFDC-HDG

Art.Nr.	L mm	T mm	F4 kN	Number of Holes	kg /100	
1394144	193	4.0	3.0	12	51	10

2af

Kwikstrut Fittings 41mm

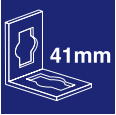

2.065

## Kwikstrut Channel Base Fittings - Deltatone

### Kwikstrut Channel Base Fittings

Material : Steel DD11 - EN 10111

Finish : Delta Tone - Corrosion resistance - EN ISO 9227

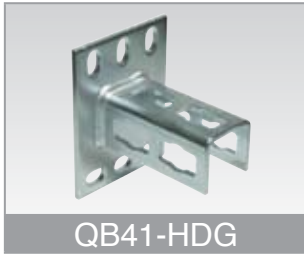

QB41-HDG

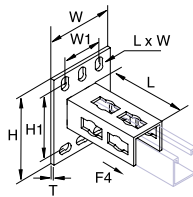

Art.Nr.	L mm	W mm	W1 mm	H mm	H1 mm	T mm	LxW mm	F4 kN	Number of Holes	Kg /100	
1394153	108	100	62	130	100	5.0	12.5x20	3.0	6	77.1	10

### Kwikstrut Channel Base Fittings

Material : Steel DD11 - EN 10111

Finish : Delta Tone - Corrosion resistance - EN ISO 9227



QB82-HDG

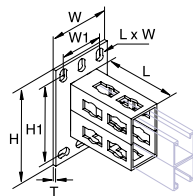

Art.Nr.	L mm	W mm	W1 mm	H mm	H1 mm	T mm	LxW mm	Number of Holes	Kg /100	
1394454	108	130	62	170	140	8.0	12.5x20	6&6	192	5

### Kwikstrut Channel Base Fittings

Material : Steel DD11 - EN 10111

Finish : Delta Tone - Corrosion resistance - EN ISO 9227



QB124-HDG

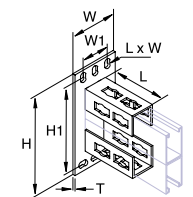

Art.Nr.	L mm	W mm	W1 mm	H mm	H1 mm	T mm	LxW mm	Number of Holes	Kg /100	
1396654	108	130	62	210	180	8.0	12.5x20	6&6	224.6	5

2ag

Kwikstrut Fittings 41mm

TYCENSUP 06/09



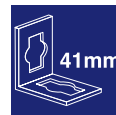

## Kwikstrut Cantilever Arms & Angle Brackets - Deltatone

### Kwikstrut cantilever arm

Material : Steel DD11 - EN 10111

Finish : Deltatone

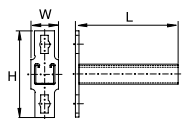

QLCA-HDG

Art.Nr.	L mm	Q Kg /100	
1394116	200	75.2	10
1394126	250	87.3	10
1394136	350	111.3	10
1394146	450	136.2	10

### Kwikstrut adapter washer

Material : Steel DD11 - EN 10111

Finish : Deltatone

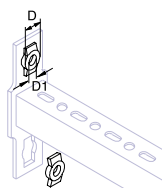

QCA-HDG

Art.Nr.	D mm	D1 mm	Q Kg /100	
1390864	27	8.5	2.1	50
1391064	27	10.5	2	50
1391264	27	12.5	1.9	50

### Kwikstrut brace fitting

Material : Steel DD11 - EN 10111

Finish : Deltatone

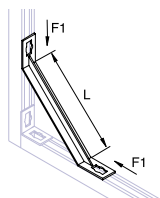

QBF-HDG

Art.Nr.	L mm	F1 kN	Q Kg /100	
1393004	300	2.0	61.6	10
1394004	400	2.0	80.6	10
1395004	500	2.0	102.6	10
1396004	600	2.0	123.7	10

2ah

Kwikstrut Fittings 41mm

TYCENSUP 06/09

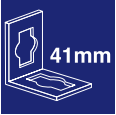

2.067

## Kwikstrut Cantilever Arms & Angle Brackets - Deltatone

### Kwikstrut angle bracket

Material : Steel DD11 - EN 10111

Finish : Deltatone

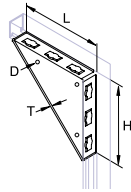

QKON-HDG

Art.Nr.	L mm	H mm	Kg /100	
1390154	195	195	99.2	10
1390164	155	210	77.8	10

### Universal brace fitting

Material : Steel DD11 - EN 10111

Finish : Deltatone

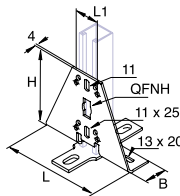

QB-HDG

Art.Nr.	L mm	L1 mm	H mm	Kg /100	
1391394	197	50	147	70	10

### U bolt for universal brace

Material : Steel DD11 - EN 10111

Finish : Deltatone

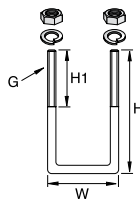

QUB-HDG

Art.Nr.	G	H mm	H1 mm	Kg /100	
1392164	M8	65	35	6.4	20
1394164	M8	85	35	7.6	20
1394264	M8	125	35	10.1	20
1396264	M8	108	35	9	20
1396364	M8	167	35	13	20

2ah

Kwikstrut Fittings 41mm

TYCENSUP 06/09